



DC6000

DC AIR CONDITIONER



6,000 BTU per Hour
50 Amps 12 Volts • 25 Amps 24 Volts
Available in 12, 24, 36, 48 & 72 Volts
Compact Design for Use in:
Day Cab, Forklift, Crane, NEV



www.SunPowerTech.com



DC6000

DC AIR CONDITIONER



Features

The DC6000 is designed to deliver 6000 BTU per hour of cooling capacity and optional 400 watts per hour of heating capacity. The Air handler is equipped with three 2" discharge vents standard. An optional 2" flange kit is available when hoses are to be attached. The DC6000 uses dual 300 CFM fans to deliver optimal airflow and recirculation and uses R134A refrigerant and standard SAE service ports. Standard Warranty is 1 year full replacement. Available in 12, 24, 36, 48, and 72 VDC



Specifications

- DC6000 uses R 134A
- Standard SAE Service Ports
- Standard warranty is 1 year – Full replacement
- Available in 12, 24, 36, 48 and 72 VDC
- Low Current Draw

Evaporator / Air Handler	24" L x 11" W x 5" H	8 LBS
Condenser / Compressor	18.5" L x 9.5" W x 9.5" H	20 LBS
Line Set - Standard	6' L	Flexible
Output	6000 BTU / Hour Cooling	Optional 400 watts/hr heating
DC Current	30 Amps @ 12 volts	8 Amps @ 48 volts
Refrigerant	R134A	Uses standard SAE service ports

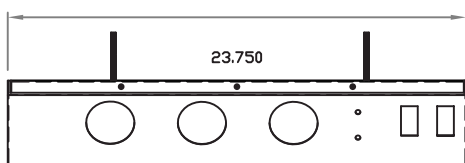

Condenser / Compressor

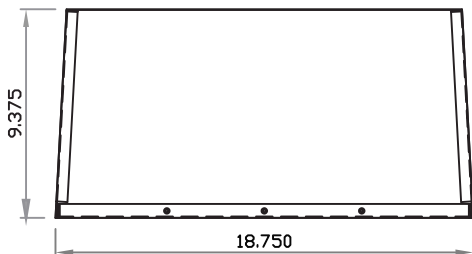
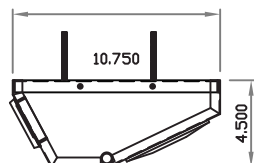

Evaporator / Air Handler

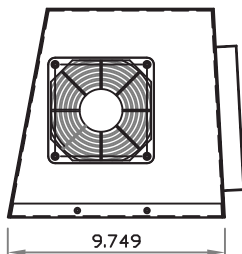

1111 3rd Avenue SW
 Carmel, IN 46032
(800) 876-6117
 Fax: (317) 663-0203
www.dccomfort.com